

# Hills Home Hub<sup>®</sup>

## HIR-808 IR DISTRIBUTION MODULE

**Description:**

The Hills Home Hub<sup>®</sup> IR (Infrared) distribution module enables family members to remotely control any electronic equipment such as an audio receiver, DVD, VCR, or Cable and Satellite receivers from any room in the house. The module can support up to eight IR control sets or applications, to go beyond this number you can make use of the IR expansion output port for further extension.

**Installation: (see Fig. 1)**

To install the module, simply insert tabs to the cap located on the rail of the enclosure. Press the fastener to lock the module at the desired position.

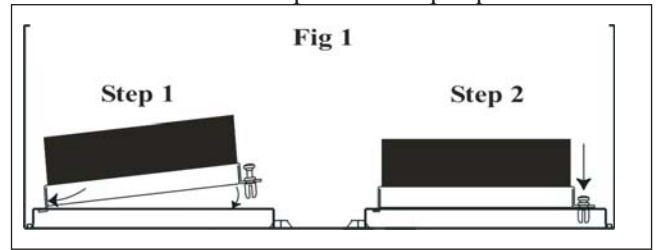

**Operation: (see Fig. 2)**

There are two rows of terminal blocks on this module. The top row has the IR Receiver blocks labelled "From Rooms" they are used to connect IR Receivers. The bottom row features the IR Emitter blocks labelled "To Rooms", they are used to connect IR Emitters.

**Connecting the IR Receiver** - Each set of IR Receiver block has three terminals which are labelled "S", "-" and "+". Strip wire (CAT5/CAT5e Solid Cable) ends 4mm and insert into this terminal block according to the following wire instruction for IR Receiver connection: "S" = White Orange, "+" = White Brown, "-" = Brown.

*Note - It is advisable to maintain identical cable colour coding for "S", "-" and "+" for all IR Receiver blocks.*

**Connect the IR Emitter** - Each set of IR Emitter block has two terminals which are "-" and "+". Strip wire cable (CAT5/CAT5e Solid Cable) ends 4mm and insert into this terminal block according to the following wire instruction for IR Emitter connection: "+" = White Green, "-" = Green.

*Note - It is advisable to maintain identical cable colour coding for "+" and "-" between IR Emitter Adapter and IR Emitter block.*

Apply a 12VDC power adapter to this IR Distribution Module and your IR system is ready to go. A power cord is included for connections to the (HPS-25W18AC or HPS-60W) Hills Home Hub<sup>®</sup> power supplies. Simply connect both ends to the proper DC sockets.

**Sensitivity Adjustment**

There is a gain/sensitivity adjustment used for tuning the amplified level. To adjust for different cable losses you can use sensitivity adjust to increase the gain and get appropriate signal levels.

**IR Receiver (HRM-1) & IR Emitter HEM-1):**

The IR Receiver (**HRM-1**) receives IR signals from a handheld remote control and transmits to all IR emitter (**HEM-1**) to control corresponding electronic devices. The transmission media is CAT 5 or CAT 5e cable. Point the handheld remote control to the IR Receiver so that the IR receiver has a straight view to receive the signal. The distance between the IR Receiver and the remote control should not exceed 5 metres.

*Note - it is recommended you install ONLY ONE IR Receiver per room.*

**IR Expansion Method:**

The Expansion Output port is used to control additional audio or video devices or to allow more rooms to control audio or video devices when applications go beyond eight. Simply connect the terminals "S" and "-" from the Expansion Output of the first HIR-808 IR Distribution Module into any one of the IR Receiver block terminals "S" and "-" of the additional HIR-808 IR Distribution Module.

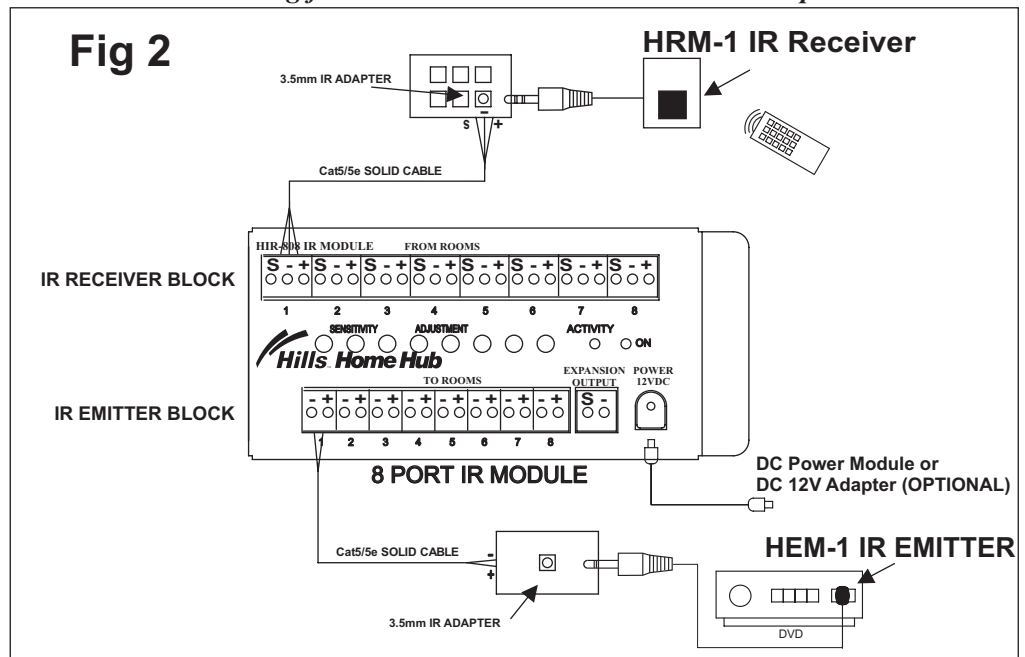

# Contact Details.

  
DIRECT ALARM SUPPLIES

A  Hills Company

**Head Office**  
10-12 Wiggs Rd  
Riverwood NSW 2210  
Ph: (02) 9717 5222  
Fax: (02) 9717 5221  
Service: 1800 252 213

12 Wentworth St  
Granville NSW 2142  
Ph: (02) 9897 7722  
Fax: (02) 9897 9477

Unit 27/17 Bowden St  
Alexandria NSW 2015  
Ph: (02) 9698 9698  
Fax: (02) 9319 1379

23/376-380 Eastern Valley Way  
Chatswood NSW 2067  
Ph: (02) 8467 1467  
Fax: (02) 8467 1499

Unit 1/43-45 Collie St  
Fyshwick ACT 2609  
Ph: (02) 6280 9630  
Fax: (02) 6280 9632

1/16 Viewtech Pl  
Rowville VIC 3178  
Ph: (03) 9755 6922  
Fax: (03) 9755 7311

Factory 5/51 Moreland Rd  
Coburg VIC 3058  
Ph: (03) 9383 2066  
Fax: (03) 9383 2173

4/276 Abbotsford Rd  
Bowen Hills QLD 4006  
Ph: (07) 3252 5512  
Fax: (07) 3252 5531

7/179-181 Currumburra Rd  
Ashmore QLD 4214  
Ph: (07) 5597 7203  
Fax: (07) 5597 3900

5 Toucan Cres  
Condon QLD 4815  
Ph: (07) 4755 1270  
Fax: (07) 4755 1271

24 Raglan Ave  
Edwardstown SA 5039  
Ph: (08) 8375 9900  
Fax: (08) 8375 9999

Unit 1/1 Natalie Way  
Balcatta WA 6021  
Ph: (08) 9240 4420  
Fax: (08) 9240 4313

219B Murray St  
Hobart TAS 7000  
Ph: (03) 6234 9455  
Fax: (03) 6234 9962



1/30 Greenpark Rd  
Penrose Auckland  
Ph: (09) 525 8007  
Fax: (09) 525 8009

Unit A1A  
5 Douglas Alexander Pde  
Nth Harbour Industrial Estate  
Albany Auckland  
Ph: (09) 525 8007  
Fax: (09) 415 7421

Unit 5/235 Waltham Rd  
Sydenham Christchurch  
Ph: (03) 374 6277  
Fax: (03) 374 6287

1B Downer St  
Lower Hutt Wellington  
Ph: (04) 939 9355  
Fax: (04) 939 9366



**Head Office**  
12 Wiggs Road  
Riverwood, NSW 2210  
(02) 9717-5290  
(02) 9717-5226

Cnr Cambria & Bridge  
Keysborough, VIC 3173  
(03) 9238-2533  
(03) 9238 2535

448 Victoria Road  
Malaga, WA 6090  
(08) 9442-5633  
(08) 9442-5644

114 Harris Road  
East Tamaki Auckland  
(9) 274-6509  
(9) 274-1063

69 Activity Street  
Acacia Ridge, QLD 4110  
(07) 3344-3855  
(07) 3344-4866

20 Raglan Avenue  
Edwardstown, SA 5039  
(08) 8371-0277  
(08) 8371-1519

7 Ackland Street  
Edwardstown, SA 5039  
(8) 8371-3663  
(8) 8371-1519